



# ST MICHAEL'S SCHOOL BASSENDEAN

## VERITAS



MERCY

*St Michael's School is a school community founded by the Sisters of Mercy in 1914. We aspire to provide a secure, caring learning environment where commitment to Faith, Truth, Service and Compassion are encouraged as a way of life.*

St Joseph's Parish,  
20 Hamilton Street, Bassendean 6054  
Parish Office: 9379 2691  
Fr Son Nguyen : 9279 1549  
Email: [bassendean@perthcatholic.org.au](mailto:bassendean@perthcatholic.org.au)

### NEWSLETTER 1

## 2nd February 2018

St Michael's School  
4 James Street, Bassendean 6054  
PO Box 428, Bassendean 6934  
Phone: 6278 9888 Absentees: 6278 9802  
[www.stmichaelsbass.wa.edu.au](http://www.stmichaelsbass.wa.edu.au)

#### WELCOME

A warm 2018 welcome to the St Michael's School Community. I would like to take this opportunity to share some inspired words that reflect a vision for the coming school year. Put simply these words are a reminder for how we can be motivated to live our lives.

**"Be the reason someone smiles today"**  
and  
**"We rise by lifting others"**

#### MAKING JESUS REAL

On Tuesday, staff participated in some professional development surrounding the "Making Jesus Real" programme. An important aspect of MJR is learning how to recognise God Moments in an encounter with a friend, a cheerful greeting, a smile, a wink of encouragement, an offer of a helping hand or an unexpected compliment. MJR leads us towards a 'winners and grinners' rather than 'moaners and groaners' approach to each day, looking for the positives and ensuring that others know how much we appreciate them in our lives. This includes passing on the Good News each day.

MJR marries the values of: showing care and compassion, respect, honesty and trustworthiness, understanding, tolerance and inclusion and embeds these values in the learning programmes across all Key Learning Areas. These values aim to encourage students to do their best, treat others fairly, be responsible for their actions and follow school rules and procedures. Central to MJR is a call to pause for 60 seconds each day and reflect on the following question, 'Where was Jesus in my life today?'

In this respect MJR ceases to be a program, rather a Christian way of life.

#### PARENT INFORMATION NIGHT

Parent Information Night will be held on Monday 5<sup>th</sup> February commencing in the Hall at 6pm. There will be two sessions after the initial welcome where you have the opportunity to hear a little about our community, vision and educational direction for 2018.

These nights are a wonderful opportunity to meet your child's teacher, enter your child's learning space and learn a little more about the collaborative practices that will form part of your child's learning journey. The teaching staff have worked hard to ensure that the night is informative and engaging.

#### WELCOME MORNING TEA

It was lovely to see many parents welcome in the 2018 school year at the annual Welcome Morning Tea this Friday for new and returning families. Thank you to the P&F who always go above and beyond in organising this wonderful community building initiative.

Finally, I wish to thank you all for the very warm welcomes I have had this week, both from the students and families.

*Lisa Liebrechts - Principal*



### *Dates for your Diary*

Mon	5 Feb	Parent Information Night
Fri	9 Feb	Assembly
Wed	14 Feb	Ash Wednesday Mass—Yr 3
Fri	16 Feb	Assembly
		Yr 6 T 20 Cricket Carnival
		P&F Function - Scitech Family Night
Mon	19 Feb	Reconciliation - Parent Information Evening - 5.00pm
Mon	19 Feb	P&F and Board Meeting 6.00pm
Fri	23 Feb	Assembly
Sat	24 Feb	Sacrament Commitment Mass - Yr 3, Yr 4, & Yr 6
Sun	25 Feb	Sacrament Commitment Mass - Yr 3, Yr 4, & Yr 6

Giving respect is one of the most important element in a person's life -  
It is like an investment.  
Whatever one gives to others shall come back to us with interest.  
Good Day!!

## Good Morning World



# Bits 'n' Bobs

## SCHOOL FEES

Our ANZ Bank Account details are as follows, for anyone wishing to pay directly into it.

**BSB: 016-255 ACC: 4247 69155**

*Your name must be included in any payments made through the bank account.*

Alternatively, direct debit forms are available from the school office if you wish to set up a regular payment.

If you wish to apply for **HCC discount** on the tuition fee portion of the account, please come to the office to fill in a HCC form and present a copy of your concession card.

## ABSENTEE LINE: 6278 9802

Please phone the number above if your child is absent from school. We ask that you do not email individual class teachers regarding absence, but use the dedicated phone line instead. You will also need to give a **signed note** of explanation to the class teacher on your child's return to school.

## NO PARKING IN KISS AND RIDE!

Please don't park in the Kiss & Ride and leave your vehicle. It badly impedes the flow of traffic and holds up other families who are trying to drop children off. **If you need to help your child out of the car or escort them to the classroom, please park your car elsewhere.**

## OUR SCHOOL IS A NUT FREE ZONE

St Michael's School is an Allergy Friendly School. We have students who can experience a **life threatening** reaction to tasting, touching or smelling nuts.

**Students should not bring ANY items of food where the key ingredient is nuts.** This means pastes such as Nutella and Peanut Butter; raw nuts such as almonds, pistachios, cashews and peanuts; or foods with nuts as a main ingredient, such as muesli bars or chocolate bars containing nuts. **We ask that these products not be brought to school.**

## REMINDER - LATE ARRIVALS

Parents, if your child gets to school **LATER THAN 8:40am** a parent/guardian **MUST SIGN THEM IN** at the Office so the Roll can be adjusted. Thank you for your cooperation.

## TRASH FREE TUESDAY

We ask that on every Tuesday you are mindful of the way you package your children's lunchbox to minimize waste at our school. Ideally we would love to see no wrappers, and all food packaged into containers.

## CONTACT DETAILS

If your phone numbers, address, or email address change, please don't forget to tell the Office, as it is vital that we have accurate contact details for both parents. Please also give us an update if your child's emergency contact person's details change. Thank you for your cooperation.

## ABSENCE CALLS / NOTES / EMAILS

Please note, teachers do not get to sit down and check their emails first thing in the morning, so if you have emailed the teacher regarding your child's absence, they may not receive the information until later in the day. Therefore, please do not be upset if you receive an SMS or phone call from the Office to clarify the absence. For this reason, a phone call to the ABSENTEE LINE is a more efficient way of communicating an absence than an email.

Please note also, a SIGNED NOTE also needs to be provided to the teacher on your child's return to school. The Department of Education Services has confirmed that whilst an SMS or phone message is NOT a substitute for a signed note when reporting absences, **an email meeting the following criteria** can be accepted:

- the **full name** of the student
- the **class / roll group** of the student
- the **reason** for the absence
- the **full name of the parent/guardian** at the end of the message (the 'from' email address is not sufficient).

## CANTEEN NEWS

Welcome back everyone.

Please support your school canteen which is open on

Mondays, Wednesdays  
and Fridays

For both recess and lunch.

We offer a great range of food,  
at very modest prices.

**UNIFORM SHOP OPENING HOURS**  
**TUESDAY and FRIDAY**  
**mornings 8:30 - 9:15am**



## Accessing the **CONNECTED** App for St Michael's, Bassendean



### 1. Download the App



Simply follow the link...

<http://q-r.to/baixCA>

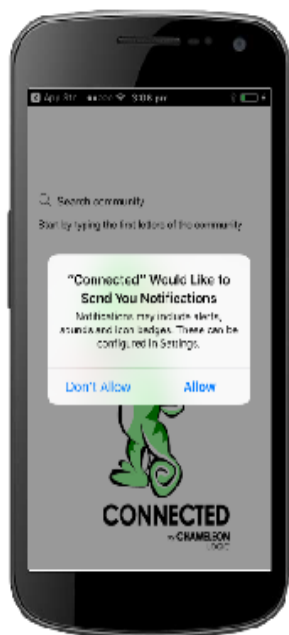

### 2. Allow Notifications

For Apple or iOS devices you'll be asked if you would like to Allow Push Notifications or Not ... click "Allow" or "OK".



### 3. Subscribe to St Michael's, Bassendean

Be greeted with the Search page. Simply start typing the name of the School "St Michael's, Bassendean". When the name appears simply click on it and the app will open.



## CONGRATULATIONS!

You can now receive critical real time information when you really need to and to where you really need it – straight to your smartphone or tablet.



## ST MICHAEL'S SCHOOL - TERM ONE CALENDAR 2018 (as at 26.1.18)

	MONDAY	TUESDAY	WEDNESDAY	THURSDAY	FRIDAY	SAT/SUN
<b>WEEK 1</b> <b>FEBRUARY</b>	29/1 STAFF PD	30/1 STAFF PD COMMISSIONING MASS 4.30 pm Cathedral	31/1 STUDENTS COMMENCE Staff Meeting	1/2	2/2 Welcome Morning Tea P&F <b>ASSEMBLY</b>	3/2  4/2
<b>WEEK 2</b> <b>FEBRUARY</b>	5/2 PARENT INFORMATION NIGHT 6.00-6.15 Hall Session 1 6.20 Session 2 7.00	6/2	7/2  STAFF MEETING	8/2	9/2 <b>ASSEMBLY</b>  Gymnastics Commence	10/2  11/2
<b>WEEK 3</b> <b>FEBRUARY</b>	12/2	13/2 CAPA Regional Meeting 2pm Marina & Ryan  Pancake Race Day – Montessori BIC Yrs4-6	14/2 <b>ASH WEDNESDAY</b> <b>MASS YR 3</b> <b>Valentine's Day</b> SAM CLUB MEETING	15/2  SSCS Meeting 2pm – Nat B	16/2 <b>ASSEMBLY</b> <b>P&amp;F Function</b> <b>SCI-TECH</b> <b>Family Fun</b> <b>Night</b> Year 6 T20 Cricket Carnival	17/2  18/2
<b>WEEK 4</b> <b>FEBRUARY</b>  <b>Kagan Coaching</b> On Entry Assessment	19/2 Lisa at Leaders Forum  BOARD AND P&F MEETING 6pm <b>RECONCILIATION PARENT INFORMATION EVENING</b> 5pm	20/2	21/2  PLC MEETING	22/2	23/2  <b>ASSEMBLY</b>	24/2 <b>Sacrament Commitment</b> Mass Yr 3, 4 & 6 25/2 <b>Sacrament Commitment</b> Mass Yr 3, 4 & 6
<b>WEEK 5</b> <b>MARCH</b> OT Screening Kindy	26/2	27/2	28/2 <b>MASS YR 4</b> WHOLE STAFF MEETING	1/3 Nat and Neala Jolly Phonics PD ½ day	2/3 <b>ASSEMBLY</b>	3/3  4/3
<b>WEEK 6</b> <b>MARCH</b> OT Screening Kindy	5/3 <b>PUBLIC HOLIDAY</b> <b>LABOUR DAY</b>	6/3	7/3 PLC MEETING Chris LSL	8/3  Chris LSL	9/3 <b>ASSEMBLY</b> Chris LSL	10/3  11/3
<b>WEEK 7</b> <b>MARCH</b> OT Screening Kindy	12/3 Lisa Regional Principal Meeting 1pm CAPA Members Day Marina & Ryan Chris LSL Nicky LSL	13/3 Swimming Trials Chris LSL	14/3 <b>MASS YR 6</b>  SAM CLUB MEETING	15/3 Schoenstatt Shrine Yr 3 Kathy Walker PD Lisa, Ryan & Marina	16/3 <b>ASSEMBLY</b> Interschool Cricket Carnival	17/3 St Patrick's Day 18/3
<b>WEEK 8</b> <b>MARCH</b> On Entry Assessment <b>Kagan Coaching</b> <b>Interviews</b>	19/3 BOARD AND P&F MEETING 6pm	20/3 Back up Cricket Carnival	21/3 First Reconciliation Ceremony 6pm No Meeting	22/3	23/3 <b>ASSEMBLY</b>	24/3  25/3 Palm Sunday
<b>WEEK 9</b> <b>MARCH</b> <b>Interviews</b>	26/3	27/3 Swimming Carnival	28/3 STAFF MEETING Stations of the Cross	29/3 Holy Thursday	30/3 <b>Good Friday</b>	31/3  1/4 Easter
<b>WEEK 10</b> <b>APRIL</b> <b>Interviews</b>	2/4 <b>EASTER MONDAY</b>	3/4 <b>EASTER TUESDAY</b>	4/4 PLC MEETING Jo LSL	5/4 Jo LSL	6/4 <b>ASSEMBLY</b> Gymnastics Concludes Jo LSL	7/4  8/4
<b>WEEK 11</b> <b>APRIL</b> <b>Interviews</b>	9/4 <b>COMMUNION PARENT INFORMATION EVENING</b> 5pm Jo LSL	10/4	11/4 <b>MASS YR 5</b> Jo LSL	12/4	13/4 <b>ASSEMBLY</b> END OF TERM Jo LSL	14/4  15/4